



COMMERCIAL HEAVY DUTY PROTECTION PLANS



**Comprehensive
coverage for your
peace of mind**

Premium 2000 Supreme is the most comprehensive coverage with no limits on repairs and labor rates.*

TODAY. TOMORROW. TOGETHER.

*See contract for details and conditions.

© 2025 NTP

ULTRA2 COVERAGE

HEAVY DUTY CLASS 8

Retail

- Model year <10 years including calendar year
- Starting mileage <900,000 miles, expires at 1,000,000 miles
- Included Rapid Repair Guarantee Plus®
- 3 tows reimbursed for covered claim, up to \$350 each
- \$350 deductible
- No labor rate caps

GENEROUS COVERAGE AND LIMITS OF LIABILITY

Engine
Fuel Injectors, Water Pump, Fuel Pump, and ECM
Turbocharger
Aftertreatment
Transmission / Rear Differential
Comfort package®
Electronix Package™
APU
Aggregate

LOL

NO LIMIT
NO LIMIT
NO LIMIT
\$8,000 / \$12,000 one box
NO LIMIT
\$6,000
\$6,000
\$4,000
Actual Cash Value

Term	Deductible	Model Years 2021 and Newer			Model Years 2019 - 2020			Model Years 2018 and Older		
		< 400K	400K - 600K	600K+	< 400K	400K - 600K	600K+	< 400K	400K - 600K	600K+
12MTH / 100K Miles	\$350	\$4,540	\$4,640	\$5,140	\$4,840	\$5,040	\$5,540	\$5,240	\$5,540	\$5,940
12MTH / 125K Miles	\$350	\$5,140	\$5,240	\$5,840	\$5,440	\$5,540	\$6,140	\$5,840	\$6,140	\$6,540
18MTH / 150K Miles	\$350	\$6,110	\$6,540	\$7,280	\$6,510	\$7,020	\$7,780	\$7,120	\$7,730	\$8,500
18MTH / 175K Miles	\$350	\$6,690	\$7,160	\$7,980	\$7,110	\$7,600	\$8,460	\$7,750	\$8,400	\$9,220
24MTH / 200K Miles	\$350	\$7,570	\$8,340	\$9,310	\$8,070	\$8,890	\$9,920	\$8,890	\$9,810	\$10,960
24MTH / 250K Miles	\$350	\$8,130	\$8,970	\$10,010	\$8,670	\$9,560	\$10,670	\$9,560	\$10,550	\$11,790
36MTH / 300K Miles	\$350	\$9,980	\$11,020	\$12,310	\$10,650	\$11,760	\$13,140	\$12,400	\$13,710	\$15,300
36MTH / 400K Miles	\$350	\$11,080	\$12,230	\$13,680	\$11,820	\$13,060	\$14,610	\$13,870	\$15,320	\$16,970

Additional Coverages	12 Months	18 Months	24 Months	36 Months
Trans & Rears	\$540	\$650	\$760	\$970
Comfort Package	\$670	\$880	\$1,080	\$1,370
Electronix Package	\$590	\$690	\$790	\$990
Roadside Assistance	\$400	\$500	\$650	\$850
APU	\$490	\$490	\$490	\$490

Rental Truck	7 Days	14 Days
	\$160	\$320

Valid for 60 days after: 1/24/2025

Dealer Presentation © 2025 HD350M500

Prevent Costly Repair Surprises

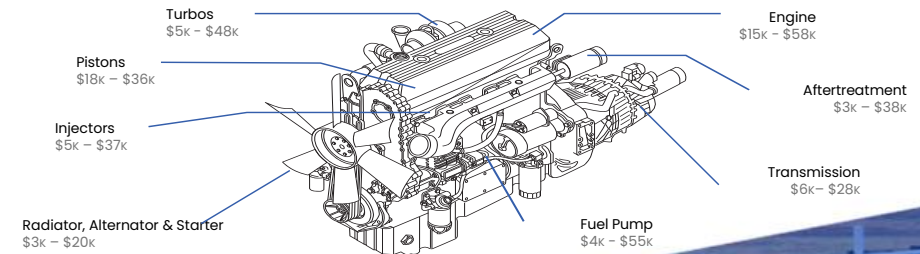

TODAY. TOMORROW. TOGETHER.

SUPREME COVERAGE

HEAVY DUTY CLASS 8 Retail

- Model year <10 years including calendar year
- Starting mileage <900,000 miles, expires at 1,000,000 miles
- Included Rapid Repair Guarantee Plus®
- 3 tows reimbursed for covered claim, up to \$350 each
- \$350 deductible
- No labor rate caps

GENEROUS COVERAGE AND LIMITS OF LIABILITY

Engine
 Fuel Injectors, Water Pump, Fuel Pump, and ECM
 Turbocharger
 Aftertreatment
 Transmission / Rear Differential
 Comfort package®
 Electronix Package™
 APU
 Aggregate

LOL

NO LIMIT
 NO LIMIT
 NO LIMIT
 \$8,000 / \$12,000 one box
 NO LIMIT
 \$6,000
 \$6,000
 \$4,000
 Actual Cash Value

Term	Deductible	Model Years 2021 and Newer			Model Years 2019 - 2020			Model Years 2018 and Older		
		< 400K	400K - 600K	600K+	< 400K	400K - 600K	600K+	< 400K	400K - 600K	600K+
12MTH / 100K Miles	\$350	\$4,540	\$4,640	\$5,140	\$4,840	\$5,040	\$5,540	\$5,240	\$5,540	\$5,940
12MTH / 125K Miles	\$350	\$5,140	\$5,240	\$5,840	\$5,440	\$5,540	\$6,140	\$5,840	\$6,140	\$6,540
18MTH / 150K Miles	\$350	\$6,110	\$6,540	\$7,280	\$6,510	\$7,020	\$7,780	\$7,120	\$7,730	\$8,500
18MTH / 175K Miles	\$350	\$6,690	\$7,160	\$7,980	\$7,110	\$7,600	\$8,460	\$7,750	\$8,400	\$9,220
24MTH / 200K Miles	\$350	\$7,570	\$8,340	\$9,310	\$8,070	\$8,890	\$9,920	\$8,890	\$9,810	\$10,960
24MTH / 250K Miles	\$350	\$8,130	\$8,970	\$10,010	\$8,670	\$9,560	\$10,670	\$9,560	\$10,550	\$11,790
36MTH / 300K Miles	\$350	\$9,980	\$11,020	\$12,310	\$10,650	\$11,760	\$13,140	\$12,400	\$13,710	\$15,300
36MTH / 400K Miles	\$350	\$11,080	\$12,230	\$13,680	\$11,820	\$13,060	\$14,610	\$13,870	\$15,320	\$16,970

Additional Coverages	12 Months	18 Months	24 Months	36 Months
Trans & Rears	\$540	\$650	\$760	\$970
Comfort Package	\$670	\$880	\$1,080	\$1,370
Electronix Package	\$590	\$690	\$790	\$990
Roadside Assitance	\$400	\$500	\$650	\$850
APU	\$490	\$490	\$490	\$490

	7 Days	14 Days
Rental Truck	\$160	\$320

Prevent Costly Repair Surprises

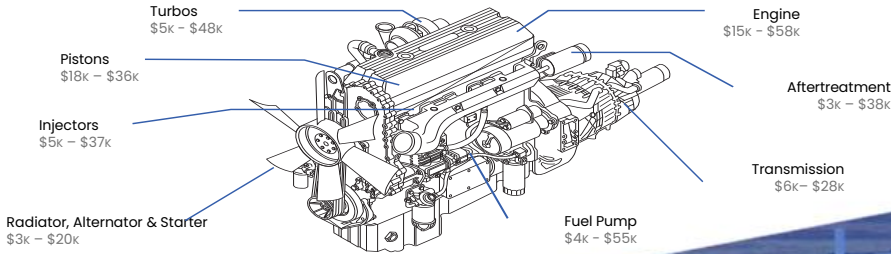

Valid for 60 days after: 1/24/2025
 Dealer Presentation © 2025 HD350M 500

TODAY. TOMORROW. TOGETHER.

PREFERRED COVERAGE

HEAVY DUTY CLASS 8

Retail

- Model year <10 years including calendar year
- Starting mileage <900,000 miles, expires at 1,000,000 miles
- Included Rapid Repair Guarantee*
- 3 tows reimbursed for covered claim, up to \$350 each
- \$175 labor rate cap
- \$350 deductible

GENEROUS COVERAGE WITH HIGH LIMITS OF LIABILITY LOL

Engine	\$25,000
Fuel Injectors, Water Pump, Fuel Pump, and ECM	\$6,000
Turbocharger	\$7,500
Aftertreatment	\$8,000
Transmission / Rear Differential	\$7,500 / \$7,500
Comfort package®	\$6,000
Electronix Package™	\$6,000
APU	\$4,000
Aggregate	Lesser of ACV* or \$35,000

*ACV is the Actual Cash Value

Term	Deductible	Model Years 2021 and Newer			Model Years 2019 - 2020			Model Years 2018 and Older		
		< 400K	400K - 600K	600K+	< 400K	400K - 600K	600K+	< 400K	400K - 600K	600K+
12MTH / 100K Miles	\$350	\$4,230	\$4,340	\$4,750	\$4,540	\$4,640	\$4,950	\$4,850	\$4,950	\$5,570
12MTH / 125K Miles	\$350	\$4,750	\$4,850	\$5,260	\$5,050	\$5,160	\$5,570	\$5,360	\$5,460	\$6,180
18MTH / 150K Miles	\$350	\$5,310	\$5,730	\$6,090	\$5,570	\$5,980	\$6,340	\$6,290	\$6,800	\$7,320
18MTH / 175K Miles	\$350	\$5,780	\$6,240	\$6,600	\$6,030	\$6,500	\$6,910	\$6,850	\$7,360	\$7,980
24MTH / 200K Miles	\$350	\$6,290	\$7,010	\$7,320	\$6,500	\$7,220	\$7,630	\$7,630	\$8,550	\$8,960
24MTH / 250K Miles	\$350	\$6,700	\$7,520	\$7,830	\$6,910	\$7,730	\$8,140	\$8,240	\$9,160	\$9,680
36MTH / 300K Miles	\$350	\$9,160	\$10,290	\$10,810	\$9,470	\$10,700	\$11,110	\$11,220	\$12,650	\$13,270
36MTH / 400K Miles	\$350	\$10,190	\$11,520	\$12,040	\$10,600	\$11,930	\$12,550	\$12,650	\$14,190	\$14,910

Additional Coverages	12 Months	18 Months	24 Months	36 Months
Trans & Rears	\$540	\$650	\$760	\$970
Comfort Package	\$670	\$880	\$1,080	\$1,370
Electronix Package	\$590	\$690	\$790	\$990
APU	\$490	\$490	\$490	\$490
Roadside Assistance	\$400	\$500	\$650	\$850
Rapid Repair Guarantee Plus®	\$100	\$100	\$100	\$100

	7 Days	14 Days
Rental Truck	\$160	\$320

Prevent Costly Repair Surprises

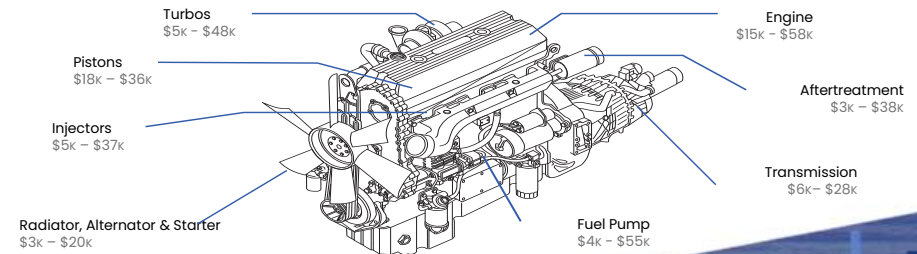

Valid for 60 days after: 1/24/2025
Dealer Presentation © 2025 HD350M500

TODAY. TOMORROW. TOGETHER.

Repair costs based on NTP / Premium 2000 claims data. See contract for complete coverage and conditions © 2025 National Truck Protection Co., Inc.

HEAVY DUTY CLASS 8

Retail

- Model year <10 years including calendar year
- Starting mileage <900,000 miles, expires at 1,000,000 miles
- Included Rapid Repair Guarantee*
- 3 tows reimbursed for covered claim, up to \$350 each
- \$175 labor rate cap
- \$350 deductible

GENEROUS COVERAGE WITH HIGH LIMITS OF LIABILITY LOL

Engine	\$25,000
Fuel Injectors, Water Pump, Fuel Pump, and ECM	\$6,000
Turbocharger	\$7,500
Aftertreatment	\$8,000
Transmission / Rear Differential	\$7,500 / \$7,500
Comfort package®	\$6,000
Electronix Package™	\$6,000
APU	\$4,000
Aggregate	Lesser of ACV* or \$35,000

Term	Deductible	Model Years 2021 and Newer			Model Years 2019 - 2020			Model Years 2018 and Older		
		< 400K	400K - 600K	600K+	< 400K	400K - 600K	600K+	< 400K	400K - 600K	600K+
12MTH / 100K Miles	\$350	\$4,230	\$4,340	\$4,750	\$4,540	\$4,640	\$4,950	\$4,850	\$4,950	\$5,570
12MTH / 125K Miles	\$350	\$4,750	\$4,850	\$5,260	\$5,050	\$5,160	\$5,570	\$5,360	\$5,460	\$6,180
18MTH / 150K Miles	\$350	\$5,310	\$5,730	\$6,090	\$5,570	\$5,980	\$6,340	\$6,290	\$6,800	\$7,320
18MTH / 175K Miles	\$350	\$5,780	\$6,240	\$6,600	\$6,030	\$6,500	\$6,910	\$6,850	\$7,360	\$7,980
24MTH / 200K Miles	\$350	\$6,290	\$7,010	\$7,320	\$6,500	\$7,220	\$7,630	\$7,630	\$8,550	\$8,960
24MTH / 250K Miles	\$350	\$6,700	\$7,520	\$7,830	\$6,910	\$7,730	\$8,140	\$8,240	\$9,160	\$9,680
36MTH / 300K Miles	\$350	\$9,160	\$10,290	\$10,810	\$9,470	\$10,700	\$11,110	\$11,220	\$12,650	\$13,270
36MTH / 400K Miles	\$350	\$10,190	\$11,520	\$12,040	\$10,600	\$11,930	\$12,550	\$12,650	\$14,190	\$14,910

Additional Coverages	12 Months	18 Months	24 Months	36 Months
Trans & Rears	\$540	\$650	\$760	\$970
Comfort Package	\$670	\$880	\$1,080	\$1,370
Electronix Package	\$590	\$690	\$790	\$990
APU	\$490	\$490	\$490	\$490
Roadside Assistance	\$400	\$500	\$650	\$850
Rapid Repair Guarantee Plus®	\$100	\$100	\$100	\$100

	7 Days	14 Days
Rental Truck	\$160	\$320

Prevent Costly Repair Surprises

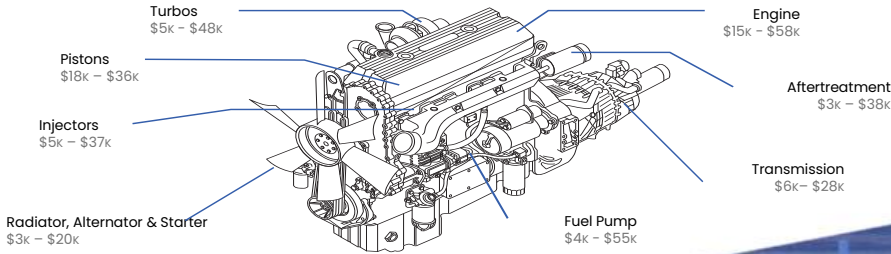

Valid for 60 days
 Dealer Presentation © 2025 HD350M500

TODAY. TOMORROW. TOGETHER.